



CV-M532/M535

Remote Head Monochrome CCD Camera



- ***High resolution monochrome 1/3" Hyper HAD IT CCD sensor***
- ***EIA: 768 (h) x 494 (v) pixels***
- ***Remote head \varnothing 12. Cable length 2 or 5 m***
- ***Improved dynamic range and smear performance***
- ***High S/N ratio >56 dB***
- ***Interlaced or non-interlaced scanning***
- ***Field or frame integration mode***
- ***Internal, external HD/VD or random synchronization***
- ***HD/VD synchronization input/output - TTL or 75 Ohm***
- ***Edge pre-select, pulse width control and start/stop trigger modes***
- ***Long time exposure with external VD pulses***
- ***Exposure enable EEN, write enable WEN and pixel clock output***
- ***Framegrabber friendly interface***
- ***Camera functions and CCU housing identical with CV-M50***

The leading manufacturer of high performance camera solutions

Specifications for CV-M532/CV-M535 EIA

Specifications	CV-M532/M535
Scanning system	525 lines, 30 frames/sec.
CCD sensor	Monochrome 1/3" Hyper HAD IT CCD
Sensing area	4.9 mm (h) x 3.7 mm (v)
Effective picture elements	768 (h) x 494 (v)
Elements in video output	758 (h) x 486 (v)
Cell size	6.35 (h) x 7.4 (v) μ m
Resolution	
Horizontal	570 TV lines
Vertical	485 TV lines
Sensitivity on sensor	0.2 Lux, Max gain, 50% video
S/N ratio	>56 dB (AGC off, Gamma 1)
Video output	Composite VS signal 1.0 Vpp, 75 Ohm
Gamma	0.45 or 1.0
Gain	Manual - Automatic 0 to +15 dB
Scanning	2:1 interlaced - non-interlaced
Accumulation	Field - Frame
Synchronization	Int. X-tal. Ext HD/VD or random trigger
HD sync. input/output	4V, 75 Ohm *
VD sync. input/output	4V, 75 Ohm *
Trigger input	4V, 75 Ohm *
Trigger input duration	>64 μ sec.
WEN out (write enable)	4V, 75 Ohm
EEN out (exposure enable)	4V, 75 Ohm
Pixel clock output (optional)	4V, 75 Ohm, sine
Shutter modes	Internal, Edge pre-select, Pulse width control, Start/stop, Long time integration
Edge pre-select	1/60, 1/125, 1/250, 1/500, 1/1000, 1/2000, 1/4500, 1/10,000 second
Pulse width control	<1000 H
Start/stop trigger	1/77 to 1/10,000 second
Long time exposure	1 field to ∞ Duration between ext. VD pulses
Operating temperature	-5°C to +45°C
Humidity	20 - 80% non-condensing
Power	12V DC \pm 10%. 3.7W
Dimensions, CCU	40 x 50 x 80 mm (HxWxD)
Weight, CCU	210 g
Lens mount	Special M10.5 x 0.5
Dimensions	\varnothing 12 x 50 mm
Cable length to head	
CV-M532	2 m
CV-M535	5 m
Weight, camera head	5 g

* HD sync., VD sync./ (trigger) input or output by internal jumpers. Factory setting HD/VD input. Inputs TTL or 75 Ohm terminated by internal jumpers. Factory setting: 75 Ohm terminated.

Switch Setting

	OFF	ON	
SHUTTER	1	2	1/60 off
	3	4	1/125
	5	6	1/250
	7	8	1/500
			1/1000
			1/2000
			1/4500
			1/10,000
			Seconds
TRIGGER	Normal	<>	External
ACCUMM	Field	<>	Frame
INTERLACE	Interlaced	<>	Non-interlaced
GAMMA	1.0	<>	0.45
GAIN	Manual	<>	Auto

Rear view

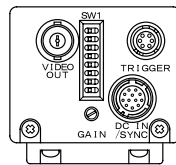

Ordering Information

CV-M532E 1/3" Remote Head Monochrome CCD Camera. EIA. 2 m cable
CV-M535E 1/3" Remote Head Monochrome CCD Camera. EIA. 5 m cable

Connection Description

DC-IN/SYNC.

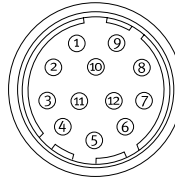

- Pin 1 Ground
2 +12V DC
3 Ground
4 Video output
5 Ground
6 HD input/HD output
7 VD input/VD output
8 Ground
9 Pixel clock output (Optional)
10 Ground
11 +12V DC
12 Ground

TRIGGER

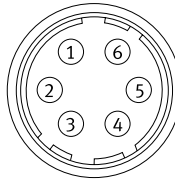

- Pin 1 N.C.
2 EEN output
3 Ground
4 N.C.
5 Trigger input
6 WEN output

Spectral Sensitivity

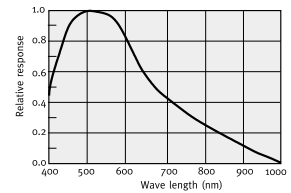

Dimensions

Front view

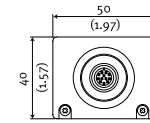

Side view

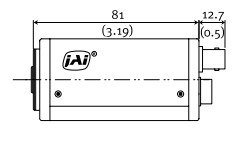

Bottom view

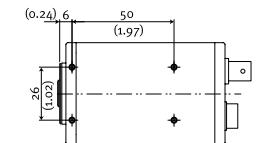

Top view

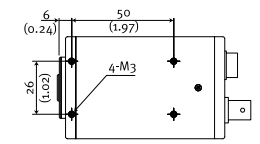

Camera Head Dimensions

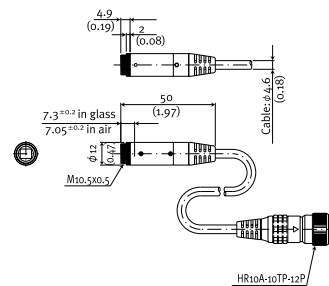

JAI A-S, Denmark
Phone +45 4457 8888
Fax +45 4491 8880
www.jai.com

JAI Corporation, Japan
Phone +81 45 933 5400
Fax +81 45 931 6142
www.jai-corp.co.jp

JAI UK Ltd., England
Phone +44 1442 879 669
Fax +44 1442 879 281
www.jai.com

JAI Vision OY, Finland
Phone +358 9 8256220
Fax +358 9 870 3345

JAI America Inc., USA
Phone (Toll-Free) +1 877 472-5909
Phone +1 949 472-5900
Fax +1 949 472-5908
www.jai.com



THE MECHADEMIC COMPANY

Visit our web site on www.jai.com